

Standard D081

As of: April 10, 2026

| Description    | Model | Carton Quantity    |
|----------------|-------|--------------------|
| DUK 81 -27X2NN | D081  | 150 pcs per Carton |

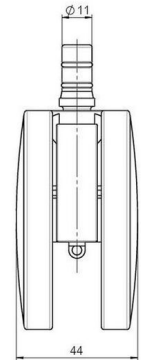
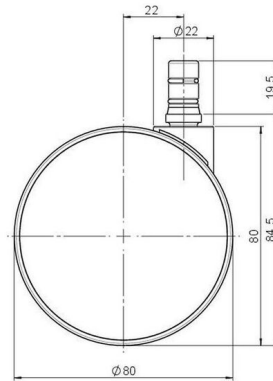

## Technical Details

|                            |  |
|----------------------------|--|
| Product Type               | Furniture caster   |
| Wheel diameter             | 80mm   |
| Load capacity              | 80kg   |
| Overall height with fixing | 84,5mm   |
| <b>Wheel:</b>              |  |
| Wheel type                 | Soft wheel   |
| Wheel core / tread color   | RAL 9005 Jet black / RAL 9005 Jet black                              |
| <b>Housing:</b>            |  |
| Housing form               | unhooded, with neck diameter   |
| Neck diameter              | 22mm   |
| Housing material           | High quality nylon   |
| Housing color              | RAL 9005 Jet black   |
| Mobility concept           | Freewheel  |
| Fixing                     | No-Noise™ Stem, 11x19,5mm Push fit stem with double circlips, 11,4mm |
| Description                | DUK 81 -27X2NN   |

## Fixings

Compatible with the following available fixings:

### No-Noise™ Stem:

- 11x19,5mm with 11,4mm circlip
- 11x19,5mm with 110,6mm circlip

### Push fit stems:

- 10x22mm with 10,3mm circlip
- 10x22mm with 10,5mm circlip
- 11x19,5mm with 11,4mm circlip
- 11x19,5mm with 11,8mm circlip
- 11x22mm with 11,4mm circlip
- 11x22mm with 11,6mm circlip
- 11x22mm with 11,8mm circlip

### Threaded stems:

- M8x15mm
- M8x20mm
- M8x25mm
- M10x15mm
- M10x20mm
- M10x25mm
- M10x30mm
- M10x40mm
- M12x20mm

### Square plates:

- 38x38mm
- 55x55mm
- 60x60mm